

13/3/79

36

To: Manager

Assay results Intoryche raisebore pilot hole samples

Sample no	Description	Sn	% Assay	Sn
208	315.73 To 317.07 METRES	0.04	0.10	
209	317.07 " 318.58 "	0.04	0.07	
210	318.58 " 320.09 "	0.04	0.08	
211	320.09 " 321.60 "	0.04	0.08	
212	321.60 " 323.12 "	0.01	<0.01	
213	323.12 " 324.64 "	0.01	<0.01	
214	324.64 " 326.16 "	0.01	0.01	
215	326.16 " 327.68 "	0.02	0.08	
216	327.68 " 329.06 "	0.02	0.02	
217	329.06 " 330.58 "	0.01	0.01	
218	330.58 " 331.94 "	0.03	0.03	
219	331.94 " 333.95 "	0.04	0.07	
220	333.95 " 334.96 "	0.06	0.09	
221	334.96 " 336.47 "	0.04	0.05	
222	336.47 " 337.99 "	0.06	0.06	
223	337.99 " 339.49 "	0.03	0.07	
224	339.49 " 340.99 "	0.04	0.05	
225	340.99 " 342.50 "	0.07	0.08	
226	342.50 " 344.02 "	0.04	0.07	
227	344.02 " 345.49 "	0.01	0.02	
228	345.49 " 347.01 "	0.02	0.01	
229	347.01 " 348.54 "	0.04	0.02	
230	348.54 " 350.05 "	0.07	0.09	
231	350.05 " 351.56 "	0.04	0.07	
ARITHMETIC	Avg. 208 TO 231	0.03	0.05	
"	" 1 TO 231	0.05	0.05	

Data entry 7/7/14 PDL

ASSAY RESULTS ON LUTWYCHE SAMPLES

SAMPLE NO.	% Sn	% WO ₃	SAMPLE NO.	% Sn	% WO ₃
L 9	0.01	0.14	L 28	0.01	0.06
10	<0.01	0.12	29	0.01	0.02
11	<0.01	0.06	30	0.04	1.17
12	0.07	0.07	31	<0.01	0.02
13	<0.01	0.05	32	0.02	0.33
14	3.51	3.72	33	0.04	12.18
15	<0.01	7.42	34	0.01	0.10
16	9.14	7.45	35	0.01	0.05
17	0.13	1.48	36	0.07	0.14
18	<0.01	0.03	37	0.02	0.43
19	0.05	1.13	38	0.01	0.09
20	0.01	0.16	39	0.01	0.48
21	0.01	0.05	40	(Lost Sample During Preparation).	
22	0.01	0.03	41	0.05	3.40
23	0.03	1.51	42	0.01	0.27
24	<0.01	0.07	43	0.03	0.69
25	0.02	0.03	44	0.02	0.01
26	<0.01	0.05			
27	<0.01	0.28			

PARTICULARS OF SAMPLES FOR ASSAY

[illegible]

. 22nd August . 1968 . . DATE

7-11-55

PARTICULARS OF SAMPLES FOR ASSAY

7-11-55

.....R. Watchorn.....SAMPLER

... 3.9.68 ... DATE

... 3.9.68 ... DATE

Senior Geologist
Chief Geol. A.M.P.L.

PARTICULARS OF SAMPLES FOR ASSAY

[illegible]

R. Watchorn SAMPLER
9th Sept. 1968 DATE

• ABERFOYLE HOLDINGS LTD.

MINING DIVISION

LUTWYCHE EXPLORATION PROJECT

PARTICULARS OF SAMPLES FOR ASSAY

[illegible]

Distribution:-

Orig - File Geol. Office
Copies Mine Manager ✓ (B)

Senior Geologist
Chief Geol. A.M.P.L.

..... R. Watson SAMPLER

.....20/9/18.....DATE

PARTICULARS OF SAMPLES FOR ASSAY

[illegible]

.....24th Sept 1968.....DATE

PARTICULARS OF SAMPLES FOR ASSAY

[illegible]

...30th Sept. 1968....DATE

PARTICULARS OF SAMPLES FOR ASSAY

[illegible]

.....DATE

ABERFOYLE HOLDINGS LTD.

MINING DIVISION

LUTWYCHE EXPLORATION PROJECT

PARTICULARS OF SAMPLES FOR ASSAY

SAMPLE NO.	P A R T I C U L A R S	ASSAY	
		Sn.	WO ₃
L 189	<i>Centre</i> Lutwyche lgn vein 13L Main X-cut TW. 3 1/2" <i>13L Main X-cut 7535N/2695E approx.</i>	0.03	0.01
L 190	Lut. lgn vein, 4' above rail, SE Wall T.W. 2 1/2" 13L Main X-cut 7535N/2695E approx.	1.61	0.26
L 191	Lut. lgn vein, 4' above rail N.W. wall T.W. 3" 13L Main X-cut 7535N/2695E approx.	2.18	0.18
L 192	Lut. lgn vein, <i>Centre</i> T.W. 13L Main X-cut 7546N/2704E approx.	0.21	9.07
L 193	Lut. lgn vein 4' above rail SE Wall. T.W. 3" 13L Main X-cut 7546N/2704E approx.	3.72	0.04
L 194	Lut. lgn vein, 4' above rail N.W. Wall. T.W.	4.91	1.88
L 195	Lut. lgn vein <i>Centre</i> T.W. 3"	5.56	2.75
L 196	"Link Vein" 13L Main X-cut. T.W. 5 1/4"	3.67	0.04
L 197	" " " " 2 1/2' S. side. T.W. 5"	0.06	0.04
L 198	" " " " 5' S. side T.W. 5"	0.01	0.02

Distribution:-

Orig - File Geol. Office
 Copies Mine Manager ☒ (BT)
 Senior Geologist
 Chief Geol. A.M.P.L.

... *A. W. Atkinson* ... SAMPLER
 *A. P. Oct. 1968* DATE

ABERFOYLE HOLDINGS LTD.

MINING DIVISION

LUTWYCHE EXPLORATION PROJECT

PARTICULARS OF SAMPLES FOR ASSAY

SAMPLE NO.	P A R T I C U L A R S	ASSAY FOR	
		Sn.	WO ₃
L199	Main Cross cut 7'6" South TW 7"	5.70	0.20
	Link vein 7443 N/2644 E		
L200	16' South TW 1 1/4"	1.31	0.05
	" "		
L201	17'6" South TW 5"	0.05	0.06
	" "		
L202	20' South TW 3"	0.11	0.11
	" "		
L203	22'6" South TW 6"	0.17	0.10
	" "		
L204	25' South TW 6"	0.03	0.06
	" "		
L205	27'6" South TW 6"	0.03	0.03
	" "		
L206	30' South TW 3"	0.02	0.06
	" "		
L207	32'6" South TW 2 1/2"	0.01	0.04
	" "		
L208	7421 N/ 2632 E 35' South TW 5"	0.03	12.52

Distribution:-

Orig - File Geol. Office
 Copies Mine Manager ✓ (M)
 Senior Geologist
 Chief Geol. A.M.P.L.

... R. Watson SAMPLER
 8th Oct 1968 DATE

ABERFOYLE HOLDINGS LTD.

MINING DIVISION

LUTWYCHE EXPLORATION PROJECT

PARTICULARS OF SAMPLES FOR ASSAY

SAMPLE NO.	P A R T I C U L A R S	ASSAY FOR	
		Sn.	WO ₃
L209	Main Crosscut 37'6" South TW 4"	0.08	0.13
L210	" " 40' South TW 2 1/2"	1.16	0.16
L211	" " 42'6" South TW 7'	0.16	0.08
L212	" " 45' South TW 7 1/2"	7.92	0.06
L213	" " 47'6" South TW 5"	1.88	1.72
L214	" " 50' South TW 4 3/4"	0.57	0.11
L215	" " 52'6" South TW 5"	0.27	0.08
L216	Crosscut & Drive Corner 55' South TW 4"	0.14	0.10
	Coords. 7404N / 2622E		
L217	" " 2'6" NW TW 3"	0.05	0.13
L218	" " 5' NW TW 3 1/2"	0.28	0.08
L224	" " 7'6" NW TW 4 1/2"	20.01	32.8
L225	" " 10' NW TW 5'	0.31	0.18
L226	" " 12'6" NW TW 5"	0.01	4.41

Distribution:-

Orig - File Geol. Office

Copies Mine Manager 

Senior Geologist

Chief Geol. A.M.P.L.

...R. J. .....SAMPLER

....8th...Oct. 1968.....DATE

PARTICULARS OF SAMPLES FOR ASSAY

Data entry
7/7/11 *OK*

12:06
12:09

ABERFOYLE HOLDINGS LTD.

MINING DIVISION

LUTWYCHE EXPLORATION PROJECT

PARTICULARS OF SAMPLES FOR ASSAY

SAMPLE NO.	P A R T I C U L A R S			ASSAY	
				FOR	
				Sn.	WO ₃
L263	Link Vein	45 NW	Tap width 13"	0.07	0.12
L264	"	47'6"	" 11"	0.08	0.02
L265	"	50' "	" 13"	1.74	0.56
L266	"	52'6"	" 16"	0.07	0.02
L267	"	55' "	" 14"	0.05	0.55
L268	"	57'6"	" 20"	0.08	1.44
L269	"	60' "	" 16"	1.69	0.42
L270	"	62'6"	" 15"	1.96	13.71
L271	"	65' "	" 17"	0.04	5.63
L272	"	67'6"	" 10"	0.03	1.50
L273	"	70' "	" 8"	0.37	0.88
L274	Bottom Vein	72'6"	" 7"	0.05	0.08
L275	"	75' "	" 6"	0.05	0.03
L276	"	77'6"	" 2"	0.03	0.44
L277	"	80' "	" 4"	0.03	0.04
L278	Top Vein	68'9"	" 5"	0.03	0.23
L279	"	71'6"	" 7"	0.96	0.03
L280	"	74' "	" 8"	0.84	0.04
L281	"	76'6"	" 12"	0.06	0.12
L282	"	79' "	" 13"	0.32	0.07

Distribution:-

Orig - File Geol. Office
Copies Mine Manager ✓

Senior Geologist
Chief Geol. A.M.P.L.

...B. Watkinson.....SAMPLER

...29th Oct. 1968.....DATE

5-11-68

ABERFOYLE HOLDINGS LTD.

MINING DIVISION

LUTWYCHE EXPLORATION PROJECT

PARTICULARS OF SAMPLES FOR ASSAY

[illegible]

Distribution:-

Orig - File Geol. Office

Copies Mine Manager

Senior Geologist

Chief Geol. A.M.P.L.

Rwatches.....SAMPLER

2nd Oct. 1968.....DATE

Form A.

ABERFOYLE HOLDINGS LIMITED - MINING DIVISION

LUTWYCHE EXPLORATION PROJECT

PARTICULARS OF SAMPLES FOR ASSAY.

[illegible]

Distribution :

Orig. File - Geol. Office

Copies: Mine Manager ✓ (85) 26/11/68

Senior Geologist

Chief Geologist, A.M.P.L.

RB Watchman Sampler.

23rd Nov Date.

PARTICULARS OF SAMPLES FOR ASSAY

[illegible]

... 6th November 1965 ... DATE

130

LUTWYCHE EXPLORATION PROJECT

[Handwritten signature]

Distribution :

R. W. Lachorn Sampler.

18th November 1968 Date.

Chief Geologist, A.M.P.L.

PARTICULARS OF SAMPLES FOR ASSAY

[illegible]

15-11-68

Form A.

ABERFOYLE HOLDINGS LIMITED - MINING DIVISION

LUTWYCHE EXPLORATION PROJECT

PARTICULARS OF SAMPLES FOR ASSAY.

SAMPLE NO.	PARTICULARS	ASSAY FOR	
		Sn	WO ₃
L308A	Link vein 194' NW from right TW 13 1/2" (Grade 7597 N) 2546 E	0.01	0.02
L309A	" " 196 1/2' " " " 17"	0.05	0.01
L310A	" " 199' " " " 16"	0.01	0.04
L311A	" " 201 1/2' " " " 17"	0.01	0.02
L312A	" " 204' " " " 17"	0.10	0.03
L313A	" " 206 1/2' " " " 10"	0.11	0.08
L314A	" " 209' " " " 12"	2.11	0.02
L392	" " 211 1/2' " " " 14"	0.01	0.03
L393	" " 214' " " " 13"	1.70	0.06
L394	" " 216 1/2' " " " 12"	0.06	0.02
L395	" " 219' " " " 12"	0.22	0.05
L396	" " 221 1/2' " " " 13" 7607 N / 2582 E	0.78	0.18

Distribution :

Orig. File - Geol. Office

Copies: Mine Manager ✓ (81)

Senior Geologist

Chief Geologist, A.M.P.L.

RW alchor Sampler.

12 Dec 1968 Date.

[Signature]

Form A.

ABERFOYLE HOLDINGS LIMITED - MINING DIVISION

LUTYNCHÉ EXPLOATION PROJECT

PARTICULARS OF SAMPLES FOR ASSAY.

SAMPLE NO.	PARTICULARS	ASSAY FOR	
		Sn	WO ₃
L329	SE Drive, near main X-cut	T.W 6"	1.27 0.87
L330		T.W 5 $\frac{1}{4}$ "	0.55 1.34
L331		T.W 3 $\frac{1}{4}$ "	0.43 0.02
L332		T.W 2 $\frac{1}{2}$ "	4.92 1.44
L333		T.W 2"	0.42 0.41
L334		T.W 6 $\frac{3}{4}$ "	0.20 0.08
L335		T.W 9"	0.26 0.03
L336		T.W 6 $\frac{1}{2}$ "	0.46 0.01
L337		T.W 9"	0.21 0.66
L338		T.W 9"	0.69 0.65
L339		T.W 9'	0.07 0.02
L340		T.W 3 $\frac{3}{4}$ "	0.71 0.06
L341		T.W 9"	0.40 0.06
L342		T.W 10 $\frac{3}{4}$ "	0.93 0.03
L343		T.W 8"	

Distribution :

Orig. File - Geol. Office

Copies: Mine Manager

Senior Geologist

Chief Geologist, A.M.P.L.

Ronald C. White Sampler.

8/11/68 Date.

Date: 7/7/11
Data entry: [Signature]

ABERFOYLE HOLDINGS LIMITED - MINING DIVISION

LUTYCHE EXPLORATION PROJECT

PARTICULARS OF SAMPLES FOR ASSAY.

SAMPLE NO.	PARTICULARS	ASSAY FOR	
		Sn	WO ₃
L343	TW 8"	1.48	2.86
L344	" 8 3/4"	0.27	0.04
L345	" 7 1/2"	0.11	0.22
L346	" 8 1/4"	0.11	0.03
L347	End of Vein 3' 1" from 13L04 " 6 3/4"	0.21	2.91
L357	New Vein 6' 11" from 13L04 " 2 1/4"	0.14	3.08
L358	" 2 1/2"	0.26	0.81
L359	" 5 3/4"	0.20	0.03
L360	" 8"	7.90	0.03
L361	" 10 1/4"	14.31	0.05
L362	" 14 "	0.53	0.01
L363	" 7 "	1.51	0.02
L364	" 7 1/2"	0.10	0.02
L365	" 6 3/4"	1.46	8.20
L366	" 6 3/4"	0.51	0.05
L367	" 6 3/4"	1.16	0.07
L368	" 6 1/2"	0.76	0.04
L369	" 4 1/2"	0.12	0.09
L370	" 6 "	3.23	0.60
L371	" 5 3/4"	0.28	0.70
L372	" 6 1/4"	0.05	0.39

Distribution :

Orig. File - Geol. Office

Copies: Mine Manager ☒

Senior Geologist

Chief Geologist, A.M.P.L.

Ronald Culiken Sampler.
12/11/68 Date.

20-11-68

Form A:

ABERFOYLE HOLDINGS LIMITED - MINING DIVISION

LUTWYCHE EXPLORATION PROJECT

PARTICULARS OF SAMPLES FOR ASSAY.

[illegible]

Distribution :

R. B. Wetmore Sampler.

Orig. File - Geol. Office ✓

25th Nov 1968 Date.

Copies: Mine Manager ✓ 81 26/11/68

Senior Geologist

Chief Geologist, A.M.P.L.

Data entry
7/7/11
PK

Form A.

ABERFOYLE HOLDINGS LIMITED - MINING DIVISION



LUTWYCHE EXPLORATION PROJECT

PARTICULARS OF SAMPLES FOR ASSAY.

[illegible]

Distribution :

Orig. File - Geol. Office

Copies: Mine Manager  

Senior Geologist

Chief Geologist, A.M.P.L.

Ratchet Sampler.

3.12.68 Date.

Form A.

ABERFOYLE HOLDINGS LIMITED - MINING DIVISION

LUTWYCHE EXPLORATION PROJECT

PARTICULARS OF SAMPLES FOR ASSAY.

[illegible]

Distribution :

Orig. File - Geol. Office

Copies: Mine Manager ✓ (57)

Senior Geologist

Chief Geologist, A.M.P.L.

R. Watson, Sampler.

13.12.66 Date.

GC 409
16-12-68



Tasmania

TELEPHONES

METALLURGICAL RESEARCH.....
LABORATORY.....
MINES INSPECTION.....
EXPLOSIVES AND INFLAMMABLE LIQUIDS.....
REGISTRAR OF MINES.....

42431-2
2 LINES

22457

LAUNCESTON OFFICES,

287 WELLINGTON STREET,

SOUTH LAUNCESTON 28th January,
1969.

c.c. to-

Aberfoyle Management P/Ltd.
505 St. Kilda Road,
Melbourne, Vic. 3004

Aberfoyle Holdings Ltd.,
Rossarden, Tas. 7213.

Dear Sirs,

Lutwyche Exploration Project.

Herewith results of analyses on the following samples
received from you.

<u>Reg. No.</u>	<u>Sample No.</u>	<u>% Sn</u>	<u>% WO₃</u>
682749.	<u>L.444</u>	1.65	0.42
2750.	445	0.14	0.42
2751.	449	0.02	0.27
2752.	450	Nil	0.15
2753.	451	Nil	0.07
2754.	452	Nil	0.35
2755.	453	0.01	0.20
2756.	454	0.01	0.12
2757.	455	Nil	0.15
2758.	456	0.01	0.28
2759.	457	Nil	0.20
2760.	458	0.06	0.28
2761.	459	0.17	0.12
2762.	460	9.09	0.32
2763.	461	0.80	0.24
2764.	462	0.64	0.39
2765.	463	1.50	1.66
2766.	467	0.03	0.16
2767.	468	0.14	2.77
2768.	469	0.52	0.87
2769.	470	0.02	0.68
2770.	471	0.02	9.35

Mines Supt.

* Mills Supt.

* Senior Geologist

Engineer

Accidentant

U/G Manager A.L.

U/G Manager S.C.

Lutwyche Proj. Eng.

Super.

* Officer

Indust. Officer

* M. Charge

Indust. Officer

FROM Department of Mines Laboratory,
Launceston, Tasmania.

TO Aberfoyle Holdings Ltd., Rossarden.

<u>Reg. No.</u>	<u>Sample No.</u>	<u>% Sn</u>	<u>% WO₃</u>
682771.	<u>L.472</u>	0.05	1.92
2772.	473	0.59	5.69
2773.	474	0.09	1.92
2774.	475	0.17	3.03
2775.	476	0.02	0.05

Analyses by M. Wadley

Yours faithfully,

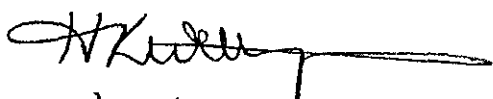
(H.K. Wellington)
Chief Chemist & Metallurgist.

Fees: \$54.00

Note. Samples may be collected at your convenience.

ABERFOYLE HOLDINGS LIMITED - MINING DIVISION

LUTYCHE EXPLORATION PROJECT

SAMPLE FORWARDING NOTE

To Dept 7 Illinois

23/12/68

SAMPLE NO.			ASSAY FOR	
			Sn	Pb
L 444	Battery type	T.W. 2"	1.65	0.42
L 445	Battery type	T.W. 2 1/2"	0.14	0.46
L 449	Battery type	T.W. 3"	0.02	0.27
L 450	Battery type, Ab type	T.W. 4"	NIL	0.14
L 451	Lutych type, Section 245' from ref pt	T.W. 4"	NIL	0.07
L 452	" Section 247 1/2 " " "	T.W. 3 1/2"	NIL	0.35
L 453	" SE " 249 1/2 " " "	T.W. 3 1/2"	0.91	0.20
L 454	" " " 251 1/2 "	T.W. 3"	0.91	0.12
L 455	Battery type, Ab type	T.W. 5"	NIL	0.15
L 456	" " Ab type	T.W. 5"	0.91	0.28
L 457	" " Ab type	T.W. 5"	NIL	0.20
L 458	Lutych type, Section 255' from ref pt	T.W. 3 1/2"	0.06	0.32
L 459	Battery type	T.W. 21"	0.17	0.2
L 460	" "	T.W. 17"	0.09	0.32
L 461	" "	T.W. 15"	0.80	0.24
L 462	" "	T.W. 16"	0.64	0.39
L 463	" "	T.W. 17 1/2"	1.50	1.66
L 467	AU 13-21, 45 3/4"	E.W. 35"	0.03	0.16
L 468	Lutych type, NW drive, 279' from ref.	T.W. 5 1/2"	0.14	2.77
L 469	" " " 281 1/2 " " "	T.W. 6"	0.52	0.87
L 470	" " " 284' " " "	T.W. 5 1/2"	0.02	0.65
L 471	" " " 268 1/2 " " "	T.W. 6 1/2"	0.02	2.35

Distribution :

Mine Manager

Chief Geologist

Senior Geologist

S

Date

ADAMS & CO. HOLDINGS LIMITED - MINING DIVISION

SAMPLE FORWARDING NOTE

TO Dept of Justice 73/12/01

SAMPLE NO.	ASSAY FOR	
	Sn	Pb
L 472 - 1/2 lb. sample, New York, 2897 ft. deep.	0.05	1.92
L 473 - 1/2 lb. sample, New York, 2898 ft. deep.	0.59	5.64
L 474 - 1/2 lb. sample, New York, 2899 ft. deep.	0.09	1.92
L 475 - 1/2 lb. sample, New York, 2900 ft. deep.	0.17	3.03
L 476 - 1/2 lb. sample, New York, 2901 ft. deep.	0.02	0.25

Form A.

ABERFOYLE HOLDINGS LIMITED - MINING DIVISION

LUTWICHE EXPLORATION PROJECT

PARTICULARS OF SAMPLES FOR "ASSAY."

Uien Samples.

[illegible]

Distribution :

Orig. File - Geol. Office

Copies: Mine Manager

Senior Geologist

Chief Geologist, A.M.P.L.

P. Buck, Sampler.

22/1/69 Date

Form A.

ABERFOYLE HOLDINGS LIMITED - MINING DIVISION

LUTWYCHE EXPLORATION PROJECT

PARTICULARS OF SAMPLES FOR ASSAY.

Vein Samples.

SAMPLE NO.	PARTICULARS	ASSAY FOR	
		Sn	WO ₃
L 489	318' V.M. D. n.p. 1. h. ch. v. TW 10"	0.26	0.01
L 491	323' " " " TW 12"	0.89	0.04
L 492	325' " " " TW 2" x 9 1/2"	0.09	0.03
L 494	330' " " " TW 9 1/2"	0.26	0.05
L 495	333' " " " TW 11"	0.62	0.21
L 496	334' " " " TW 9"	0.31	0.05
L 497	336' " " " TW 10"	0.81	0.10
L 498	338 1/2' " " " TW 10"	1.94	0.05
L 499	341' " " " TW 12"	3.21	0.72
L 500	343 1/2' " " " TW 11"	2.56	14.28
L 501	345' " " " TW 10"	14.86	1.24
L 502	348 1/2' " " " TW 10"	0.16	0.46
	L 490 - missing		
	L 493 - " <i>11.</i>		

Distribution :

Orig. File - Geol. Office

Copies: Mine Manager

Senior Geologist

Chief Geologist, A.M.P.L.

P. B. B.

Sampler.

23/1/69

Date.

Form A.

ABERFOYLE HOLDINGS LIMITED - MINING DIVISION

LUTWYCHE EXPLORATION PROJECT

PARTICULARS OF SAMPLES FOR ASSAY.

Vein samples.

[illegible]

Distribution :

Orig. File - Geol. Office

Copies: Mine Manager

Senior Geologist

Chief Geologist, A.M.P.L.

DB-100 Sampler
29/1/69 Date

Form A.

ABERFOYLE HOLDINGS LIMITED - MINING DIVISION

LUTWYCHE EXPLORATION PROJECT

PARTICULARS OF SAMPLES FOR ASSAY.

Ueni Sample.

[illegible]

Distribution :

Orig. File - Geol. Office

Copies: Mine Manager 

Senior Geologist

Chief Geologist, A.M.P.L.

P. B. L. Sampler

30/1/69 Date

Lee P.

Form A.

ABERFOYLE HOLDINGS LIMITED - MINING DIVISION

LUTWYCHE EXPLORATION PROJECT

PARTICULARS OF SAMPLES FOR ASSAY.

Vern Samples. - 13 level.

[illegible]

Distribution :

Orig. File - Geol. Office *W*

Copies: Mine Manager ✓

Senior Geologist *Wote*

Chief Geologist, A.M.P.L.

* vein splits and rejoins.

P. Beck. Sampler.

21/2/69 Date.

Form A.

ABERFOYLE HOLDINGS LIMITED - MINING DIVISION

LUTWYCHE EXPLORATION PROJECT

PARTICULARS OF SAMPLES FOR ASSAY.

Care Samples.

[illegible]

Distribution :

Orig. File - Geol. Office

Copies: Mine Manager ✓

Senior Geologist

Chief Geologist, A.M.P.L.

P. Buck Sampler

3/1/69 Date.



Form A.

ABERFOYLE HOLDINGS LIMITED - MINING DIVISION

LUTWICHE EXPLORATION PROJECT

PARTICULARS OF SAMPLES FOR ASSAY.

Here Sample

[illegible]

Distribution :

Orig. File - Geol. Office

Copies: Mine Manager 07

Senior Geologist

Chief Geologist, A.M.P.L.

P.B.G. Sampler.

6/2/69 Date.

4/24/94

ABERFOYLE HOLDINGS LIMITED - MINING DIVISION

LUTWYCHE EXPLORATION PROJECT

PARTICULARS OF SAMPLES FOR ASSAY.

Vein Samples

[illegible]

Distribution :

Orig. File - Geol. Office

Copies: Mine Manager ✓ (BT)

Senior Geologist

Chief Geologist, A.M.P.L.

P. Bush

Sampler.

7/3/69

Date.

Ly Yapp

10-3-69

1:13.4

FOR TESTER AND BOYD

REF. LUTWYCHE ASSAY RESULTS ON DATA SHEET DATED 13/3/69 -

L569	SHOULD READ	452-1/2 FT	NW OF REF. POINT
L570	" "	455 FT	NW OF REF. "
L571	" "	457-1/2 FT	NW OF REF. "

KRUMME I

6/5/69

* ref. pt. = corner rise well / 136. NW drive

LUTWICHE EXPLORATION PROJECT

SAMPLE FORWARDING NOTE

See Samples.

[illegible]

Distribution :

Mine Manager *✓*
Chief Geologist
Senior Geologist

P. B. B. Signed _____
21/2/64 Date.

LUTWICHE EXPLORATION PROJECT

SAMPLE FORWARDING NOTE

Vein Samples

SAMPLE NO.		ASSAY FOR	
		Sn	WO ₃
* L592	132, NW drive; Rise on Sect "13, SE Wall, 15' from TW 5 1/2"	0.02	0.02
L593	" " " " " 17 1/2' from TW 5 1/2"	1.52	0.04
L594	" " " " " 20' " TW 3 1/2"	0.07	0.02
+ L599	132 " off shoot, 462 1/2' from up. pt. TW 3"	0.46	0.03
L600	" " " 464 1/2' " " TW 5"	0.65	0.01
L601	" " " 466 1/2' " " TW 3"	0.28	0.02
L602	" " " 469 1/2' " " TW 3"	1.00	0.55
L603	" " Main vein 465 1/2' " " TW 8"	0.33	0.06
L604	" " " 480' " " TW 10"	16.40	0.62
L605	" " " 477 1/2' " " TW 11"	0.38	0.03
L606	" " " 475' " " TW 11"	0.10	0.46
L607	" " " 470' " " TW 10"	0.08	0.30
L608	" " " 472' " " TW 10"	0.35	0.05
L609	" " " 467 1/2' " " TW 6 1/2"	4.23	11.06
L610	" " " 463' " " TW 9"	1.61	0.10
L611	" " " 460 1/2' " " TW 11"	2.11	0.06
L612	" " " 487 1/2' " " TW 9"	0.37	0.010

Distribution :

✓ Mine Manager

Chief Geologist

Senior Geologist

Signed

Date.

* off pt. = offshoot of main vein (132 NW drive)
 + " " = " " " " (132 main vein / 132 NW drive)

28-3-60

Form A.

ABERFOYLE HOLDINGS LIMITED - MINING DIVISION

LUTWYCHE EXPLORATION PROJECT

PARTICULARS OF SAMPLES FOR ASSAY.

Vein Samples.

SAMPLE NO.	PARTICULARS	ASSAY FOR	
		Sn	WO ₃
L 631	SE DRIVE. 277 $\frac{1}{2}$ ' from u.p.l. TW 5"	0.12	3.59
L 632	" " 279 $\frac{3}{4}$ ' TW 4"	0.09	10.41
L 633	Sample to be taken at 282' TW 6"	0.12	0.07
L 636	" " 288 $\frac{1}{4}$ ' TW 6"	0.44	0.07
L 637	" " 290 $\frac{1}{2}$ ' TW 5 $\frac{1}{2}$ "	0.14	0.63
L 638	" " 292 $\frac{3}{4}$ ' TW 5"	0.04	0.05
L 639	" " 295 $\frac{3}{4}$ ' TW 4 $\frac{1}{2}$ "	0.07	0.03
L 640	" " 298 $\frac{1}{2}$ ' TW 4 $\frac{1}{2}$ "	2.12	0.09
L 641	" " 296 $\frac{3}{4}$ ' TW 4 $\frac{1}{2}$ "	0.04	0.03
L 642	" " 298' TW 6 $\frac{1}{2}$ "	0.07	0.07
L 643	" " 299' TW 7"	0.07	0.05
L 644	" " 300 $\frac{1}{2}$ ' TW 5"	0.14	0.06
L 645	" " 302' TW 4"	0.04	0.13
L 646	" " 304' TW 4 $\frac{1}{2}$ "	0.04	0.05
L 647	" " 306' TW 2 $\frac{1}{2}$ "	0.07	0.03

Distribution :

Orig. File - Geol. Office

Copies: Mine Manager *(B)*

Senior Geologist

Chief Geologist, A.M.P.L.

Richard Sampler.*8-5-69* Date.

Form A.

ABERFOYLE HOLDINGS LIMITED - MINING DIVISION

LUTWYCHE EXPLORATION PROJECT

PARTICULARS OF SAMPLES FOR ASSAY.

Vein Samples 13 Level.

SAMPLE NO.	PARTICULARS	ASSAY FOR	
		Sn	WO ₃
	<i>DRIVE. T.W.</i>		
L672	<i>Run. 13. NW DRIVE. 532' from upst 5"</i>	4.43	0.06
L673	" " " 534' " " " 7"	0.34	0.56
L674	" " " 537' " " " 6"	0.42	0.05
L675	" " " 539' " " " 8"	0.32	0.03
L676	" " " 542' " " " 7½"	0.17	0.05
L677	" " " 544' " " " 5"	0.02	0.03
L678	" " " 547' " " " 4"	0.02	0.12
L679	" " " 549' " " " 3½"	0.07	0.05
L680	" " " 552' " " " 4"	0.22	0.08
L681	" " " 554' " " " 2½"	0.26	0.09
L682	" " " 557' " " " 2"	0.12	0.07
L683	<i>Broken vein with mud & rock mixed. 559½' " " " 2"</i>	0.07	0.08
L684	<i>Same as above sample. 560' " " " 2"</i>	0.19	0.12
L685	" " " 564' " " " 2½"	7.08	0.18
L686	<i>Small vein (still main vein) 567' " " " 1¾"</i>	2.83	0.07
L687	" " " 569½' " " " 1¾"	0.08	0.06
L688	" " " 571' " " " 1½"	0.72	0.10
L689	" " " 572' " " " 2"	0.12	0.04
L690	" " " 573½' " " " 2½"	7.01	0.08
L691	" " " 574½' " " " 2"	0.06	0.09
L692	" " " 576' " " " 2½"	2.69	0.08

SW. WALL.

SW. WALL.

SW. WALL.

Distribution :

Orig. File - Geol. Office

Copies: Mine Manager ✓

Senior Geologist

Chief Geologist, A.M.P.L.

Shved Sampler.

23.5.69 Date.

206

Form A.

ABERFOYLE HOLDINGS LIMITED - MINING DIVISION

LUTWYCHE EXPLORATION PROJECT

PARTICULARS OF SAMPLES FOR ASSAY.

Vein Samples 13 Level

[illegible]

S.W.
WALL

Distribution :

Orig. File - Geol. Office

Copies: Mine Manager ✓

Senior Geologist

Chief Geologist, A.M.P.L.

Howard Sampler.

23.5.69 Date.

[Signature]

Form A.

ABERFOYLE HOLDINGS LIMITED - MINING DIVISION

LUTWYCHE EXPLORATION PROJECT

PARTICULARS OF SAMPLES FOR ASSAY.

Rise off NW Drive.

SAMPLE NO.	PARTICULARS	ASSAY FOR	
		Sn	WO ₃
L711	vein Samples. NW Drive (split) 16 1/2' from ref. pt. 4 1/2"	0.09	0.09
L712	" 17' up " " " 12"	1.59	0.08
L713	" 19 3/4' " " " 6"	1.12	0.18
L714	" 22' " " " 10"	0.17	0.04
L715	" 1 1/2' back vein included. 15 1/2"	0.24	2.04
L716	" 27 1/4' up from ref. point 14 1/2"	0.07	0.04
L717	" 30' " " " 15"	0.37	0.03
L718	" 32 1/2' " " " 11"	0.04	0.04
L719	" 35' " " " 13"	0.11	0.04
L720	" 1 1/2' 37 1/2' Rock Vein in cube 15"	0.60	0.05
L721	" 40' up from ref. pt. 14"	0.11	3.39
L722	" 42 1/2' " " " 11 1/2"	0.42	1.11
L723	" 2" 45' Rock in vein 15 1/2"	0.71	0.01
L724	" 47 1/2' up from ref. pt. 13"	0.62	0.05
L725	" 3" Rock in vein. 50' up from ref. pt. 13 1/2"	0.87	8.06
L726	" N.E. timber against vein.	-	-
L727	" 55' up from ref. point 14"	0.92	0.58
L728	" 57 1/2' " " " 13 1/2"	0.22	0.03
L729	" 59 3/4' " " " 13 1/2"	0.52	0.22
L730	" 62' " " " 13	0.34	3.35
L731	" 62' " " " 13	0.89	0.03

Distribution :

Orig. File - Geol. Office

Copies: Mine Manager

Senior Geologist

Chief Geologist, A.M.P.L.

Howard Sampler.

4.5.69 Date.

10 05 11.46 29.5.

Form A.

ABERFOYLE HOLDINGS LIMITED - MINING DIVISION

LUTWYCHE EXPLORATION PROJECT

PARTICULARS OF SAMPLES FOR ASSAY.

Thin Samples 132

[illegible]

Distribution :

P. Howard Sampler.

Orig. File - Geol. Office

1.7-69 Date.

Copies: Mine Manager.

Senior Geologist

Chief Geologist, A.M.P.L.

Form A.

ABERFOYLE HOLDINGS LIMITED - MINING DIVISION

LUTWYCHE EXPLORATION PROJECT

PARTICULARS OF SAMPLES FOR ASSAY.

main Samples 13 c.

SAMPLE NO.	PARTICULARS	ASSAY FOR	
		Sn	WO ₃
L 726	N.W. RISE. 52½' up from ref pt TW 13½"	0.34	0.41
L 749	" 70' " " " TW 12"	0.12	0.02
L 751	" 74½' " " " TW 12"	0.57	0.25
L 752	" 77' " " " TW 11½"	0.34	8.39
L 753	" 79½' " " " TW 9"	0.29	14.47
L 754	" 79½' " " " TW 6½"	1.24	10.81
L 755	" 81½' " " " TW 5½"	0.35	1.23
L 756	" 82½' " " " TW 7½"	0.04	0.69
L 757	" 84½' " " " TW 4"	0.06	0.38
L 758	" 84½' " " " TW 9"	0.09	3.23
L 759	" 86½' " " " TW 2½"	0.07	0.64
L 760	" 87' " " " TW 11"	0.12	0.25
L 765	" (only approx) 82½' TW 13"	0.04	2.62
L 766	" 81' TW 14½"	0.19	0.50

Distribution:

P. H. GUNN. Sampler.

Orig. File - Geol. Office

1-7-69 Date.

Copies: Mine Manager

Senior Geologist

Chief Geologist, A.M.P.L.

11/1/69
7-2-69

Form A.

ABERFOYLE HOLDINGS LIMITED - MINING DIVISION

LUTWYCHE EXPLORATION PROJECT

PARTICULARS OF SAMPLES FOR ASSAY.

N.W. Drive 13C.

SAMPLE NO.	PARTICULARS	ASSAY FOR	
		Sn	WO ₃
L768	N.W. Drive - 591 1/2' from ref pit TW 2 1/4"	0.14	0.13
L769	" 593 1/2' from ref pit TW 3 1/4"	0.02	0.06
L770	" 596 1/2' " " TW 3"	0.04	0.06
L771	" 598 1/2' " " TW 2 1/2"	0.02	0.05
L772	" 601' from ref pit TW 2 1/2"	0.02	0.05
L773	" 603 1/2' " " TW 2 1/2"	0.12	0.06
L774	" 606 " " TW 2 1/2"	0.07	0.07
L775	" 608 1/2' " " TW 2"	0.22	0.04
L776	No Sample TW 1 1/4"	-	-
L777	" 613 1/2' " " TW 2"	0.02	0.03
L778	" 615 1/2' " " TW 2"	1.47	0.15
L779	" 618 1/2' " " TW 2 1/4"	0.14	0.10
L780	" 620 1/2' " " TW 2"	0.07	0.04
L781	" 623 3/4' " " TW 2"	0.02	0.09
L782	No Sample TW 1 1/2"	-	-

Distribution :

Howard. Sampler.

Orig. File - Geol. Office

25.6.69. Date.

Copies: Mine Manager

Senior Geologist

Chief Geologist, A.M.P.L.

Form A.

ABERFOYLE HOLDINGS LIMITED - MINING DIVISION

LUTWYCHE EXPLORATION PROJECT

PARTICULARS OF SAMPLES FOR ASSAY.

Care Samples

[illegible]

Distribution:

Sampler.

Orig. File - Geol. Office

Date _____

Copies: Mine Manager.

Senior Geologist

Chief Geologist, A.M.B.L.

11/16/9

2-7-69

ABERFOYLE HOLDINGS LIMITED - MINING DIVISION

LUTWYCHE EXPLORATION PROJECT

PARTICULARS OF SAMPLES FOR ASSAY.

New Samples 13c.

SAMPLE NO.	PARTICULARS	ASSAY FOR	
		Sn	WO ₃
	<i>O.B.T. vein. SW. white.</i>		
L787.	" TW 16 $\frac{1}{2}$ "	0.50	0.78
L788	" TW 16 $\frac{1}{2}$ "	1.39	0.02
L789	" TW 16"	1.96	0.33
L790	" TW 17 $\frac{1}{2}$ "	1.14	3.37
L791	" TW 16 $\frac{1}{2}$ "	0.14	1.50
L792	" TW 17"	1.31	0.06
L793	" TW 17"	5.28	0.21
L794	" TW 16"	2.66	0.29
L795	" TW 18 $\frac{1}{2}$ "	0.26	3.14
L796	" TW 18"	0.72	2.59
L797	" TW 19"	0.19	0.03
L798	" TW 18 $\frac{1}{2}$ "	0.46	0.02
L799	" TW 15 $\frac{1}{2}$ "	0.04	0.02
L800.	" TW 8 $\frac{1}{2}$ "	1.24	0.07
L801	" TW 10 $\frac{1}{2}$ "	1.57	0.03
L802	" TW 7 $\frac{1}{2}$ "	0.47	0.41
L803	" TW 9"	0.27	18.64
L804	" TW 9 $\frac{1}{2}$ "	0.37	0.13
L805	" TW 8 $\frac{1}{2}$ "	3.72	0.07
L806	" TW 8"	1.14	0.03

Distribution :

Orig. File - Geol. Office

Copies: Mine Manager ✓

Senior Geologist

Chief Geologist, A.M.P.L.

P. Howard Sampler.*14/7/69.* Date.*28-7-69*

Form A.

ABERFOYLE HOLDINGS LIMITED - MINING DIVISION

LUTWYCHE EXPLORATION PROJECT

PARTICULARS OF SAMPLES FOR ASSAY.

New Samples 136

[illegible]

Distribution :

Orig. File - Geol. Office

Copies: Mine Manager

Senior Geologist

Chief Geologist, A.M.P.L.

Howard Sampler.

Date.

[Signature]

PARTICULARS OF SAMPLES FOR ASSAY.

[Signature]

ABERFOYLE HOLDINGS LIMITED - MINING DIVISION

LUTWICHE EXPLORATION PROJECT

PARTICULARS OF SAMPLES FOR ASSAY.

SAMPLE NO.	PARTICULARS	Length (in)	ASSAY FOR	
			Sn	WO ₃
	13 level thin samples.	(75)		
L844	OBT. E. NTH. Dve.	14"	0.67	15.78
L845	"	13½"	4.24	0.08
L846	"	12"	3.28	0.34
L847	"	10"	2.08	0.05
L848	"	5½"	5.80	1.85
L849	"	7½"	1.93	1.76
L850	"	7"	0.22	2.25
L851	"	7½"	3.55	0.12
L852	"	8½"	0.39	0.02
L853	"	9"	4.40	0.07
L854	"	8"	0.11	0.02
L855	"	7"	1.25	16.11
L856	"	6"	1.29	0.16
L857	"	6"	1.22	0.12
L858	"	5"	1.31	0.05
L859	"	5"	1.28	0.03
L860	"	4½"	0.15	0.02
L861	"	3½"	1.46	0.05
L862	"	2"	0.23	0.10
L863	"	2½"	2.23	0.04
L864	"	2½"	0.07	1.11

Distribution :

Orig. File - Geol. Office

Copies: Mine Manager ✓

Senior Geologist

Chief Geologist, A.M.P.L.

AS Sampler.

4.11.69 Date.

ABERFOYLE HOLDINGS LIMITED - MINING DIVISION

LUTWICHE EXPLORATION PROJECT

PARTICULARS OF SAMPLES FOR ASSAY.

SAMPLE NO.	PARTICULARS	(Grain) T ₂	ASSAY FOR	
			Sn	WO ₃
	<i>13 level vein samples</i>			
L865	OBTJ E. (NTH. DYE)	2 1/2"	0.56	0.11
L866		2"	0.15	0.24
L867		3 1/2"	3.30	0.03
L868		3"	0.09	0.70
L869		3"	0.85	0.17
L870		2 1/2"	0.31	0.08
L871		2 1/2"	0.34	0.11
L872		2 1/2"	<0.01	0.30
L873		2 1/2"	0.09	0.26
L874		3 1/2"	0.03	19.60
L875		2 1/2"	0.05	1.25
L876	(Vein too hard) No sample.		—	—
L877		4	0.10	40.03
L881	Cross Veins obt E. (NTH DYE)	4 1/2"	0.08	0.26
L882	" " "	5"	1.40	0.58

Distribution :

Orig. File - Geol. Office

Copies: Mine Manager

Senior Geologist

Chief Geologist, A.M.P.L.

 Sampler.

4.11.69 Date.

afab

[Signature]

Form A.

ABERFOYLE HOLDINGS LIMITED - MINING DIVISION

LUTWYCHE EXPLORATION PROJECT

PARTICULARS OF SAMPLES FOR ASSAY.

[illegible]

Distribution :

Orig. File - Geol. Office

Copies: Mine Manager

Senior Geologist

Chief Geologist, A.M.P.L.

P. Howard Sampler.

31.7.69 Date.

MR. MURPHY

LUTWYCHE EXPLORATION PROJECT

13 Level Core Samples

Length - 1W

Howard Sampler.

12.8.69, Date.

Senior Geologist

Chief Geologist, A.M.P.L.

ABERFOYLE HOLDINGS LIMITED - MINING DIVISION

LUTWYCHE EXPLORATION PROJECT

PARTICULARS OF SAMPLES FOR ASSAY.

SAMPLE NO.	PARTICULARS <i>Greene Samples</i>	<i>length (ft)</i>	ASSAY FOR	
			Sn	WO ₃
L91 A	NW Drive H.W. Vein (Rise 1 to 2)	14"	0.27	22.28
B	"	16½"	0.07	22.47
C	"	18"	0.54	16.14
D	"	18"	0.09	12.65
E	"	20½"	0.17	17.08
L92 A	"	21"	0.32	20.12
B	"	19½"	0.04	29.33
C	"	19½"	0.07	20.56
D	"	17½"	0.16	22.23
E	"	17"	0.06	25.11
L93 A	"	14½"	0.12	14.29
B	"	13½"	0.10	21.81
C	"	14"	0.11	22.44
D	"	15"	0.07	13.82
E	"	14½"	0.06	17.32
L94 A	"	15½"	0.10	17.14
B	"	15"	0.07	30.79
C	"	15"	0.02	30.7
D	"	16"	0.36	34.15
E	"	16"	0.09	38.45

Distribution :

Orig. File - Geol. Office

Copies: Mine Manager ✓

Senior Geologist

Chief Geologist, A.M.P.L.

 Sampler.

2.10.69 Date.

LUTYNCHÉ EXPLORATION PROJECT

PARTICULARS OF SAMPLES FOR ASSAY.

SAMPLE NO.	PARTICULARS	Length (TW)	ASSAY FOR	
			Sn	WO ₃
	<i>Groove Samples</i>			
L95 A	NW Drive H.W. Vein (Rise 1-2)	12 $\frac{1}{2}$ "	0.07	33.70
B	"	12"	0.09	22.21
C	"	13"	0.33	13.03
D	"	14"	0.040	15.44
E	"	15"	0.05	22.65
L96 A	"	17"	0.05	8.05
B	"	16 $\frac{1}{2}$ "	0.11	14.87
C	"	16 $\frac{1}{2}$ "	0.07	0.28
D	"	16 $\frac{1}{2}$ "	0.22	2.16
E	"	16"	0.040	0.07
L97 A	"	16"	0.01	0.02
B	"	16 $\frac{1}{2}$ "	0.18	0.05
C	"	16 $\frac{1}{2}$ "	0.11	0.03
D	"	16 $\frac{1}{2}$ "	0.02	0.040
E	"	17"	0.02	0.02
L98 A	"	16"	0.08	0.05
B	"	16"	0.08	0.04
C	"	15 $\frac{1}{2}$ "	0.03	0.05
D	"	15 $\frac{1}{2}$ "	2.00	0.06
E	"	18"	0.24	1.22
(additional F)	"	20"	0.01	0.05

Distribution :

Orig. File - Geol. Office

Copies: Mine Manager ✓

Senior Geologist

Chief Geologist, A.M.P.L.

Sampler.

Date.

SA

2. 10. 69

[Signature]
13-10-69

ABERFOYLE HOLDINGS LIMITED - MINING DIVISION

LUTWYCHE EXPLORATION PROJECT

PARTICULARS OF SAMPLES FOR ASSAY.

SAMPLE NO.	PARTICULARS	Depth (-T.S.)	ASSAY FOR	
			Sn	WO ₃
			16	.79
				2.48
	<i>Grane Samples</i>			
L99 A	SE O.B.T. Main	13"	0.39	0.09
B	"	17"	2.23	29.96
C	"	18½"	5.30	0.64
D	"	18½"	1.44	0.35
E	"	17"	0.66	14.80
L910 A	"	16½"	0.26	4.72
B	"	16"	0.90	0.16
C	"	17"	0.06	0.09
D	"	18"	0.31	0.04
E	"	18½"	1.23	0.08
L911 A	"	16½"	0.07	0.04
B	"	17"	0.27	7.70
C	"	17"	0.14	8.63
D	"	17"	0.72	15.90
E	"	15½"	0.65	0.41
L912 A	"	16½"	0.42	0.32
B	"	17"	0.61	0.04
C	"	17"	0.09	24.97
D	"	17"	0.32	0.09
E	"	17"	0.06	0.22
		17"	0.79	5.46

Distribution :

Sampler.

Orig. File - Geol. Office

2. 10. 69. Date.

Copies: Mine Manager ✓

Senior Geologist

Chief Geologist, A.M.P.L.

ABERFOYLE HOLDINGS LIMITED - MINING DIVISION

LUTWICHE EXPLORATION PROJECT

PARTICULARS OF SAMPLES FOR ASSAY.

SAMPLE NO.	PARTICULARS	Length (TW)	ASSAY FOR	
			Sn	WO ₃
L 913 A	Greene Samples SE. OBT Vein	18"	3.19	15.71
B	"	18"	0.31	0.90
C	"	17 1/2"	1.07	15.13
D	"	17 1/2"	1.24	1.26
E	"	17"	2.01	1.60
L 914 A	"	17"	0.16	0.87
B	"	17 1/2"	0.11	0.10
C	"	19"	1.42	7.01
D	"	19"	8.48	2.38
E	"	19"	0.11	0.38
L 915 A	"	17"	0.28	0.04
B	"	16 1/2"	2.18	0.09
C	"	17 1/2"	0.03	0.44
D	"	17 1/2"	0.40	0.09
E	"	18"	1.96	0.38
L 916 A	"	17"	1.28	0.24
B	"	17"	0.08	0.16
C	"	17"	1.02	10.97
D	"	16"	0.14	4.11
E	"	17"	0.57	0.10
		17 1/2"	1.30	3.145

Distribution :

Orig. File - Geol. Office

Copies: Mine Manager ✓

Senior Geologist

Chief Geologist, A.M.P.L.

PK - Sampler.

2. 10. 69 Date.

[Signature]

ABERFOYLE HOLDINGS LIMITED - MINING DIVISION

LUTWICHE EXPLORATION PROJECT

PARTICULARS OF SAMPLES FOR ASSAY.

SAMPLE NO.	PARTICULARS <i>Grain Samples</i>	<i>(T.L. length)</i>	ASSAY FC	
			Sn	WO ₃
L917 A	SE. OBT. 16m	16 1/2"	1.03	1.71
B	"	17"	0.78	1.7
C	"	19"	0.16	0.14
D	"	19"	0.68	1.71
E	"	18 1/2"	0.63	2.20
L918 A	"	17 1/2"	0.52	7.08
B	"	16 1/2"	3.51	3.39
C	"	17 1/2"	0.36	0.02
D	"	17 1/2"	0.13	0.03
E	"	17 1/2"	0.17	2.33
L919 A	"	17 1/2"	0.21	0.22
B	"	16 1/2"	0.16	0.06
C	"	19"	1.68	0.41
D	"	21"	0.23	0.38
E	"	17 1/2"	0.24	0.06
L920 A	"	17"	0.11	0.02
B	"	18 1/2"	0.31	0.14
C	"	18"	0.21	0.04
D	"	20"	0.07	0.03
E	"	19"	0.08	0.04
		18"	0.56	1.245

Distribution :

Orig. File - Geol. Office

Copies: Mine Manager ✓

Senior Geologist

Chief Geologist, A.M.P.L.

FA Sampler.

2-10-69 Date.

[Signature]

Form A.

ABERFOYLE HOLDINGS LIMITED - MINING DIVISION

LUTWYCHE EXPLORATION PROJECT

PARTICULARS OF SAMPLES FOR ASSAY

SAMPLE NO.	PARTICULARS	Length (TW)	ASSAY FOR	
			Sn	WO ₃
L921 A	SE. OBT vein	20 1/2"	3.15	0.03
B	"	18"	0.13	0.01
C	"	17 1/2"	0.28	0.04
D	"	13 1/2"	0.27	0.01
E	"	12 1/2"	0.05	0.16
L922 A	"	15 1/2"	0.03	0.03
B	"	15 1/2"	0.02	0.03
C	"	15"	0.21	0.04
D	"	14 1/2"	0.03	0.05
E	"	9"	0.07	0.24
L923 A	"	8 1/2"	1.06	0.21
B	"	8"	0.49	0.08
C	"	7"	0.07	0.11
D	"	7 1/2"	0.36	0.09
E	"	8 1/2"	0.13	0.30
L924 A	"	9"	2.72	0.28
B	"	9"	0.02	0.07
C	"	8 1/2"	0.03	0.03
D	"	7"	0.07	0.04
E	"	9"	0.22	0.09
		11 1/2"	0.57	0.18

Distribution :

Sampler.

Orig. File - Geol. Office

2/10/69 Date.

Copies: Mine Manager ✓

Senior Geologist

Chief Geologist, A.M.P. 12



ABERFOYLE HOLDINGS LIMITED - MINING DIVISION

LUTWICHE EXPLORATION PROJECT

PARTICULARS OF SAMPLES FOR ASSAY.

SAMPLE NO.	PARTICULARS	Length (T.W)	ASSAY FOR	
			Sn	WO ₃
L925 A	SE. @BT. vein	7 1/2"	2.34	0.03
B	"	9 1/2"	2.27	0.13
C	"	7"	0.51	0.09
D	"	15"	0.10	0.03
E	"	12"	0.10	3.26
L926 A	"	8"	0.12	4.84
B	"	8 1/2"	0.06	2.11
C	"	8"	0.06	1.26
D	"	9"	0.45	0.07
E	"	9 1/2"	0.07	0.07
L927 A	"	9 1/2"	0.01	0.02
B	"	9"	0.35	0.35
C	"	8 1/2"	6.88	1.56
D	"	8"	3.69	0.06
E	"	8"	0.27	0.04
L928 A	"	8"	0.37	0.06
B	"	8"	0.62	0.13
C	"	7"	0.40	0.06
D	"	7 1/2"	0.04	0.04
E	"	7"	0.08	22.24

Distribution :

Orig. File - Geol. Office

Copies: Mine Manager

Senior Geologist

Chief Geologist, A.M.P.L.

Ph

Sampler.

2-10-69

Date.

ROBERT

ABERFOYLE HOLDINGS LIMITED - MINING DIVISION

LUTYNCHÉ EXPLORATION PROJECT

PARTICULARS OF SAMPLES FOR ASSAY.

SAMPLE NO.	PARTICULARS		ASSAY FOR	
			Sn	WO ₃
L929A	SE CRT. vein	7 1/2"	3.59	0.13
B	"	7"	0.01	0.36
C	"	6 1/2"	0.03	0.99
D	"	7"	0.08	0.02
E	"	6 1/2"	0.04	0.06
L930A	"	6 1/2"	0.07	0.07
B	"	6"	0.11	0.03
C	"	5"	0.10	0.05
D	"	5"	0.57	0.07
E	"	5"	0.28	0.06
L931A	"	5"	0.18	0.31
B	"	5"	0.07	3.76
C	"	5"	1.91	6.54
D	"	4 1/2"	0.07	0.14
E	"	4"	0.46	1.63
L932A	"	4"	1.11	0.07
B	"	2"	1.73	0.04
C	"	2 1/2"	0.24	0.10
D	"	2"	0.06	0.03
E	"	2"	3.68	0.18
(Additional F)	"	2"	1.01	0.11

Distribution :

Orig. File - Geol. Office

Copies: Mine Manager

Senior Geologist

Chief Geologist, A.M.P.L.

A - Sampler.

2. 10 69 Date.

[Signature]
13-11-69

ABERFOYLE HOLDINGS LIMITED - MINING DIVISIONLUTWYCHE VEIN SYSTEMPRELIMINARY CHANNEL SAMPLE RESULTS :

<u>Location</u>	<u>Sample</u>	<u>True Width</u>	<u>Assay Results</u>			<u>Comment</u>
			<u>% Sn</u>	<u>% WO₃</u>	<u>% C.M.U.</u>	
13 Level Drive 2090' from datum	F1	5"	2.37	0.12	2.49	Old Battery type Vein
	F2	2"	1.40	0.40	1.80	" " " "
	F3	5½"	9.86	0.50	10.36	" " " "
	F4	6½"	3.97	23.80	27.77	" " " "
	F5	6"	0.20	0.05	0.25	" " " "
	F6	5"	0.21	0.09	0.30	" " " "
13 Level 2040' from datum	F7	1½"	0.04	0.08	0.12	Lutwyche type Vein
	F8	2"	0.79	0.09	0.88	" " "
	F9	5"	0.96	0.07	1.03	" " "
	F10	4½"	0.39	0.07	0.46	" " "
	F11	3½"	0.19	0.04	0.23	" " "
13 Level 1950' from datum	F12	2¾"	0.38	0.12	0.50	" " "
	F13	2½"	0.09	0.06	0.15	" " "
	F14	4"	0.72	0.04	0.76	" " "
	F15	4"	1.54	0.04	1.58	" " "
	F16	2"	7.70	0.05	7.75	" " "
	F17	4"	0.44	0.05	0.49	" " "
	F18	3"	0.04	0.07	0.11	" " "
13 Level	L101	11"	0.36	14.66	15.02	Hanging Wall Vein
	L102	10"	3.26	13.09	16.35	" " "
	L103	10"	3.81	18.78	22.59	" " "
	L104	8½"	0.25	0.59	0.84	" " "
	L105	7¼"	0.07	0.11	0.18	" " "
	L106		2.76	9.20	11.96	Surface S.E. Extension
	L107		0.28	0.95	1.23	" " "
	L108		0.52	0.03	0.55	" " "
	L109		0.09	0.04	0.13	" " "

ABERFOYLE HOLDINGS LIMITED - MINING DIVISION

LUTWYCHE VEIN SYSTEMPRELIMINARY CHANNEL SAMPLE RESULTS :

<u>Location</u>	<u>Sample</u>	<u>True Width</u>	<u>Assay Results</u>			<u>Comment</u>
			<u>% Sn</u>	<u>% WO₃</u>	<u>% C.M.U.</u>	
13 Level Drive 2090' from datum	F1	5"	2.37	0.12	2.49	Old Battery type Vein
	F2	2"	1.40	0.40	1.80	" " " "
	F3	5½"	9.86	0.50	10.36	" " " "
	F4	6½"	3.97	23.80	27.77	" " " "
	F5	6"	0.20	0.05	0.25	" " " "
	F6	5"	0.21	0.09	0.30	" " " "
13 Level 2040' from datum	F7	1½"	0.04	0.08	0.12	Lutwyche type Vein
	F8	2"	0.79	0.09	0.88	" " "
	F9	5"	0.96	0.07	1.03	" " "
	F10	4½"	0.39	0.07	0.46	" " "
	F11	3½"	0.19	0.04	0.23	" " "
13 Level 1950' from datum	F12	2¾"	0.38	0.12	0.50	" " "
	F13	2½"	0.09	0.06	0.15	" " "
	F14	4"	0.72	0.04	0.76	" " "
	F15	4"	1.54	0.04	1.58	" " "
	F16	2"	7.70	0.05	7.75	" " "
	F17	4"	0.44	0.05	0.49	" " "
	F18	3"	0.04	0.07	0.11	" " "
13 Level	L101	11"	0.36	14.66	15.02	Hanging Wall Vein
	L102	10"	3.26	13.09	16.35	" " "
	L103	10"	3.81	18.78	22.59	" " "
	L104	8½"	0.25	0.59	0.84	" " "
	L105	7½"	0.07	0.11	0.18	" " "
	L106		2.76	9.20	11.96	Surface S.E. Extension
	L107		0.28	0.95	1.23	" " "
	L108		0.52	0.03	0.55	" " "
	L109		0.09	0.04	0.13	" " "



TELEPHONES:

Metallurgical Research } 42431-2
 Laboratory } 2 Lines.
 Mines Inspection }
 Explosives and Inflammable Liquids }
 Registrar of Mines 22457

Department of Mines,

Launceston Office,

287 Wellington Street,

South Launceston 9th July, 1968.

c.c. to-

Aberfoyle Management Pty. Ltd.
Melbourne.

Aberfoyle Management Pty. Ltd., Mining Division,
Rossarden, Tas.

Dear Sirs,

Lutwyche Exploration Project.

Herewith results of analyses on the following samples
 received from you on 5th July, 1968.

Reg. No.	Sample No.	Results by Aber Lutwyche	Per Cent		
			WO ₃	Sn	
681314.	708	(22.55)	15.0	0.04	(0.06)
1315.	709	(1.58)	0.62	4.64	(5.50)
1316.	712	(1.52)	0.78	0.16	(0.18)
1317.	717	(3.45)	1.43	0.68	(0.88)
1318.	719	(0.04)	Nil	0.14	(0.06)
1319.	721	(0.09)	0.10	4.16	(5.30)
1320.	722	(0.03)	0.05	10.2	(14.10)
1321.	726	(0.05)	0.35	0.73	
1322.	729	(0.37)	0.10	0.74	
1323.	730	(0.64)	0.22	0.07	
1324.	731	(0.05)	Nil	0.33	
1325.	735	(1.17)	0.97	0.05	
1326.	759	(0.12)	0.30	1.79	
1327.	801	(13.81)	11.0	1.05	

Mines Super. (1.10)	
Mills Super. (2.20)	
Senior Chemist (0.95)	
Engineer (0.07)	
Accountant (0.07)	
Young Eng. Ab. (0.35)	
Mng. Eng. S.C. (0.35)	
Survey Super. (0.04)	
Mill Foreman (1.51)	
Assayer (1.25)	
Manager (0.01)	

Analyses by *[Signature]*

Yours faithfully,

[Signature]
 Chief Chemist & Metallurgist.

Fees: \$28.00

All these results are X.R.F. If you have any chemical results for them could you let me have them. At some future date we will do chemical assays ourselves.

Note.

PARTICULARS OF SAMPLES FOR ASSAY.

17. 12-69 Date.

PARTICULARS OF SAMPLES FOR ASSAY.

NB!

[illegible]

Distribution :

Orig. File - Geol. Office

Copies: Mine Manager ✓

Senior Geologist

Chief Geologist, A.M.P.L.

SA Sampler.

2.12.67 Date.

12/2/67

PARTICULARS OF SAMPLES FOR ASSAY.

Date: _____

ABERFOYLE HOLDINGS LIMITED - MINING DIVISION

LUTWYCHE EXPLORATION PROJECT

PARTICULARS OF SAMPLES FOR ASSAY.

SAMPLE NO.	PARTICULARS	ASSAY FOR	
		Sn	WO ₃
LC 1	<i>Chip Samples</i> NW (Riser-2) H.W. Ven.	0.01	19.25
LC 2	"	0.09	23.70
LC 3	"	0.06	15.45
LC 4	"	0.01	25.11
LC 5	"	0.33	24.41
LC 6	"	0.16	1.69
LC 7	"	0.04	0.16
LC 8	"	0.60	0.43
LC 9	SE. OBT Ven.	0.95	6.34
LC 10	"	7.72	0.14
LC 11	"	0.79	3.62
LC 12	"	7.41	6.56
LC 13	"	0.83	4.28
LC 14	"	0.59	4.78
LC 15	"	4.56	0.48
LC 16	"	0.44	0.82
LC 17	"	1.34	0.74
LC 18	"	0.41	1.33
LC 19	"	0.26	0.10
LC 20	"	0.14	0.12
LC 21	"	1.34	0.10

Distribution :

 Sampler.

Orig. File - Geol. Office

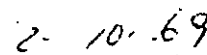
 2-10-69 Date.

Copies: Mine Manager /

Senior Geologist

Chief Geologist, A.M.P.L.



PARTICULARS OF SAMPLES FOR ASSAY

Sample Composites

[illegible]

Distribution:-

Orig - File Geol. Office
Copies Mine Manager ✓

Senior Geologist
Chief Geol. A.M.P.L.

..... R. W. Atcham SAMPLER

.....DATE

PARTICULARS OF SAMPLES FOR ASSAY

[illegible]

.....9th Sept...1968...DATE

PARTICULARS OF SAMPLES FOR ASSAY

[illegible]

.. 24 .. Sept .. 1968 DATE

Form A.

ABERFOYLE HOLDINGS LIMITED - MINING DIVISION

LUTWYCHE EXPLORATION PROJECT

PARTICULARS OF SAMPLES FOR ASSAY.

[illegible]

Distribution :

Station Sampler.

Orig. File - Geol. Office ✓

18th Nov 1968 Date.

Copies: Mine Manager ✓ (BT)

Senior Geologist

Chief Geologist, A.M.P.L.

PARTICULARS OF SAMPLES FOR ASSAY.

[illegible]

Sampler.

2. 10. 69 Date.

Copies: Mine Manager

Senior Geologist

Chief Geologist, A.M.P.L.

agob.

19-11-67

SPATCHED TODAY SCTM LOT 392 120 DRUMS 10 TONS COMPLETE.

20/3/69

FOR MASON

RE COMPOSITES

1-13.4

SAMPLE	CONSTITUENTS	%SN	%W03
LCO25	L233, L234, L235, XWRY L236	0.15	16.89
LCO26	L237, L238, L239, L240	0.26	6.96
LCO27	L241, L242, L243, L244	1.60	1.73
LCO16	L193, L194, L195	4.88	1.65

COMPOSITION LCO69 CONFIRMED.) L430 REQUIRES RESAMPLING.

LCO55 TO LCO61. THOUGHT TO BE DERIVED FROM SAMPLES IN SE DRIVE FROM LOCALITIES SINCE RE-SAMPLED. THE APPROPRIATE COMPOSITES WILL NOW REPORT UNDER LCO96 TO LCO99 INCLUSIVE, WHICH ARE NOW BEING ~~SAMPLES~~ ASSAYED.

KRUMMEI

20/3/69

Form A.

ABERFOYLE HOLDINGS LIMITED - MINING DIVISION

LUTWYCHE EXPLORATION PROJECT

PARTICULARS OF SAMPLES FOR ASSAY.

[illegible]

Distribution :

Orig. File - Geol. Office

Copies: Mine Manager ✓ (87)

Senior Geologist

Chief Geologist, A.M.P.L.

R. Watson Sampler.

15th Nov 1968 Date.

Form A.

ABERFOYLE HOLDINGS LIMITED - MINING DIVISION

LUTWYCHE EXPLORATION PROJECT

PARTICULARS OF SAMPLES FOR ASSAY.

SAMPLE NO.	PARTICULARS	ASSAY FOR	
		Sn	WO ₃
LC034	Link Ven Composite Sample L269 L270 L271 L272	0.92	5.72
LC035	" " L273 L274 L275 L276	0.11	0.14
LC036	" " L277 L278 L279 L280	0.41	0.04
LC037	" " L281 L282 L283 L284	0.09	1.15
LC038	" " L285 L286 L287 L288	0.12	2.51
LC039	" " L289 L290 L291 L292	0.03	1.41
LC040	" " L293 L294 L295 L296	0.03	2.12
LC041	" " L297 L298 L299 L300	0.03	1.06
LC042	" " L301 L302 L303 L304	0.02	1.22
LC043	" " L305 L306 L307 L308	0.11	5.45
LC044	" " L309 L310 L311 L312	2.70	7.20
LC045	SE Drive L329 L330 L331 L332	2.09	0.88
LC046	" " L333 L334 L335 L336	0.36	0.10
LC047	" " L337 L338 L339 L340	0.43	0.27
LC048	" " L341 L342 L343 L344	0.83	0.67
LC049	" " L345 L346 L347 L357	0.12	1.06
LC050	" " L357 L358 L359 L360	3.46	0.66
LC051	" " L361 L362 L363 L364	2.39	0.03
LC052	" " L365 L366 L367 L368	0.74	1.85
LC053	" " L370 L371 L372 L373	0.87	0.50
LC054	" " L374 L375 L376 L377	0.27	2.44

Distribution :

Orig. File - Geol. Office

Copies: Mine Manager (5)

Senior Geologist

Chief Geologist, A.M.P.L.

RB ~~Waters~~ Sampler.22nd Nov 1963 Date.

1.13-4.

FOR MASON

RE COMPOSITES

LC 055 - LC 061 INCLUSIVE TO BE DISREGARDED AS CONSTITUENTS
UNCERTAIN OR UNKNOWN.

SAMPLE NO.	PARTICULARS	% SN	% W03
LC 062	L382, L383, L384, L385, L386	0.26	0.82
LC 063	L313, L314, L392, L393	0.55	1.12
LC 064	L394, L395, L396, L397	0.18	0.09
LC 065	L403, L404, L405, L406	0.52	0.06
LC 066	L407, L408, L409, NR L410	0.17	0.04
LC 067	L411, L412, L419, L420	0.16	0.06
LC 068	L421, L422, L423, L424	0.42	0.42
LC 070	L431, L432, L468, L469	0.33	1.01
LC 071	L470, L471, L472, L473	0.31	4.81
LC 072	L294A, L295A, L296A, L297A	0.08	0.26
LC 073	L298A, L299A, L300A, L301A	0.03	0.91
LC 074	L302A, L303A, L304A, L305A	0.11	12.80

LC 081 INCLUDES INDIVIDUAL L490 - NOW SAMPLED AND SUBMITTED
FOR ASSAY.

LC 082 INCLUDES INDIVIDUAL L493 - NOT YET SAMPLED

.....KRUMMEI

FOR PARISH

PLEASE ARRANGE ACCOMMODATION FOR IAN MACPHERSON FOR TUESDAY NIGHT
AND ADVISE .

TITCOMBE

14/3/69

GA

Form A.

ABERFOYLE HOLDINGS LIMITED - MINING DIVISION

LUTWYCHE EXPLORATION PROJECT

PARTICULARS OF SAMPLES FOR ASSAY.

Composites

SAMPLE NO.	PARTICULARS	ASSAY FOR	
		Sn	WO ₃
LC062	L382, L383, L384, L385, L386	0.26	0.82
LC063	L313, L314, L392, L393	0.55	1.12
LC064	L394, L395, L396, L397	0.18	0.09
LC065	L403, L404, L405, L406	0.52	0.01
LC066	L407, L408, L409, L410	0.17	0.04
LC067	L411, L412, L419, L420	0.16	0.06
LC068	L421, L422, L423, L424	0.42	0.41
LC070	L431, L432, L468, L469	0.33	1.01
LC071	L470, L471, L472, L473	0.31	4.8
LC072	L294A, L295A, L296A, L297A	0.08	0.26
LC073	L298A, L299A, L300A, L301A	0.03	0.91
LC074	L302A, L303A, L304A, L305A	0.11	12.8

Distribution :

Orig. File - Geol. Office

Copies: Mine Manager ⁽⁸⁾

Senior Geologist

Chief Geologist, A.M.P.L.

P. Bick Sampler.

10/2/69 Date.

Form A.

ABERFOYLE HOLDINGS LIMITED - MINING DIVISION

LUTWYCHE EXPLORATION PROJECT

PARTICULARS OF SAMPLES FOR ASSAY.

complicated.

[illegible]

Distribution :

Orig. File - Geol. Office

Copies: Mine Manager ✓ 

Senior Geologist

Chief Geologist, A.M.P.L.

12 B.C. Sampler.

21/12/07 Date.

Geoff

Form A.

ABERFOYLE HOLDINGS LIMITED - MINING DIVISION

LUTWYCHE EXPLORATION PROJECT

PARTICULARS OF SAMPLES FOR ASSAY.

Confucius.

[illegible]

Distribution :

Orig. File - Geol. Office

Copies: Mine Manager *W*

Senior Geologist

Chief Geologist, A.M.P.L.

P. B. C. Sampler.

14/ 3/ 69 Date.

Form A.

ABERFOYLE HOLDINGS LIMITED - MINING DIVISION

LUTWICHE EXPLORATION PROJECT

PARTICULARS OF SAMPLES FOR ASSAY.

Composite Samples. 13 level.

[illegible]

Veen Wold
samples

Distribution :

Orig. File - Geol. Office

Copies: Mine Manager ✓

Senior Geologist

Chief Geologist, A.M.P.L.

Sampler.

Date.

Form A.

ABERFOYLE HOLDINGS LIMITED - MINING DIVISION

LUTWYCHE EXPLORATION PROJECT

PARTICULARS OF SAMPLES FOR ASSAY.

Composite Samples 13c

[illegible]

Distribution: *Thinned* Sampler.

Orig. File = Geol. Office 27-69 Date.

Copies: Mine Manager. ✓

Senior Geologist

Chief Geologist, A.M.P.L.

Ed. J. A. 1911

7-69

111

ABERFOYLE HOLDINGS LIMITED - MINING DIVISION

LUTWICHE EXPLORATION PROJECT

PARTICULARS OF SAMPLES FOR ASSAY.

Composite Samples 132.

[illegible]

Distribution :

Orig. File - Geol. Office

Copies: Mine Manager ✓

Senior Geologist

Chief Geologist, A.M.P.L.

Shaw Sampler.

3. 7. 69. Date.

[Signature]
2-69

2700 E

Grone Samples OBT

7200 N

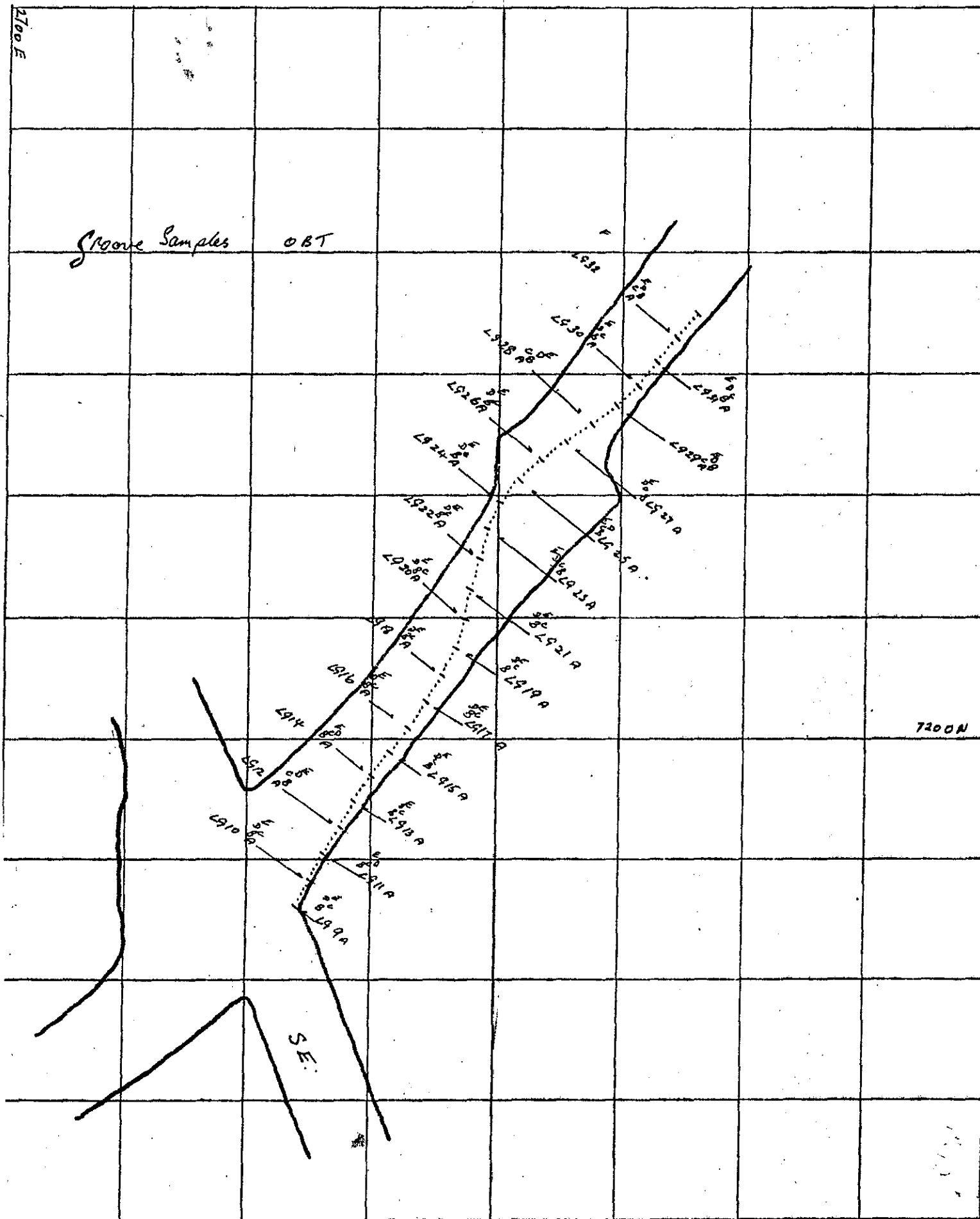

7. Flowchart - Co

L91	A	→ 0.27	22-28	14"
	B	→ 0.07	22-27	16"
	C	→ 0.54	16-41	18"
	D	→ 0.09	12-85	16"
	E	→ 0.17	17-08	20 1/2"
L92	A	→ 0.32	20-12	21"
	B	→ 0.04	29-33	19 1/2"
	C	→ 0.07	20-56	19 1/2"
	D	→ 0.16	21-23	17 1/2"
	E	→ 0.06	25-11	17"
L93	A	→ 0.12	42-59	14 1/2"
	B	→ 0.10	21-81	13 1/2"
	C	→ 0.11	22-41	14"
	D	→ 0.07	13-82	16"
	E	→ 0.06	17-32	10 1/2"
L94	A	→ 0.10	17-44	15 1/2"
	B	→ 0.07	30-79	15"
	C	→ 0.07	30-74	15"
	D	→ 0.32	34-45	16"
	E	→ 0.09	38-45	16"
L95	A	→ 0.07	33-70	13 1/2"
	B	→ 0.04	22-21	12"
	C	→ 0.33	13-03	13"
	D	→ 0.04	15-44	14"
	E	→ 0.05	22-65	15"
L96	A	→ 0.05	8-05	17"
	B	→ 0.11	14-87	16 1/2"
	C	→ 0.07	0-28	16 1/2"
	D	→ 0.22	2-16	16 1/2"
	E	→ 0.04	0-07	16"
L97	A	→ 0.01	0-02	16"
	B	→ 0.18	0-03	16 1/2"
	C	→ 0.11	0-03	16 1/2"
	D	→ 0.02	0-04	16 1/2"
	E	→ 0.02	0-02	17"
L98	A	→ 0.02	0-05	16"
	B	→ 0.03	0-04	16"
	C	→ 0.03	0-05	15 1/2"
	D	→ 2.00	0-06	15 1/2"
	E	→ 0.24	1-22	13"
	F	→ 0.01	0-05	20"

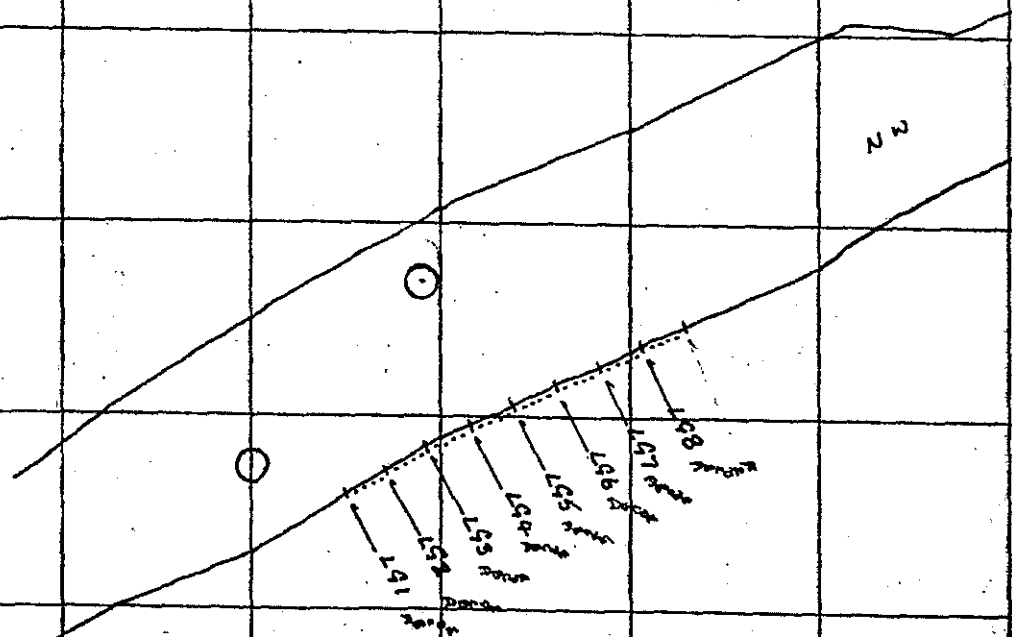

NOV

2700E

Chip Samples 1:10'

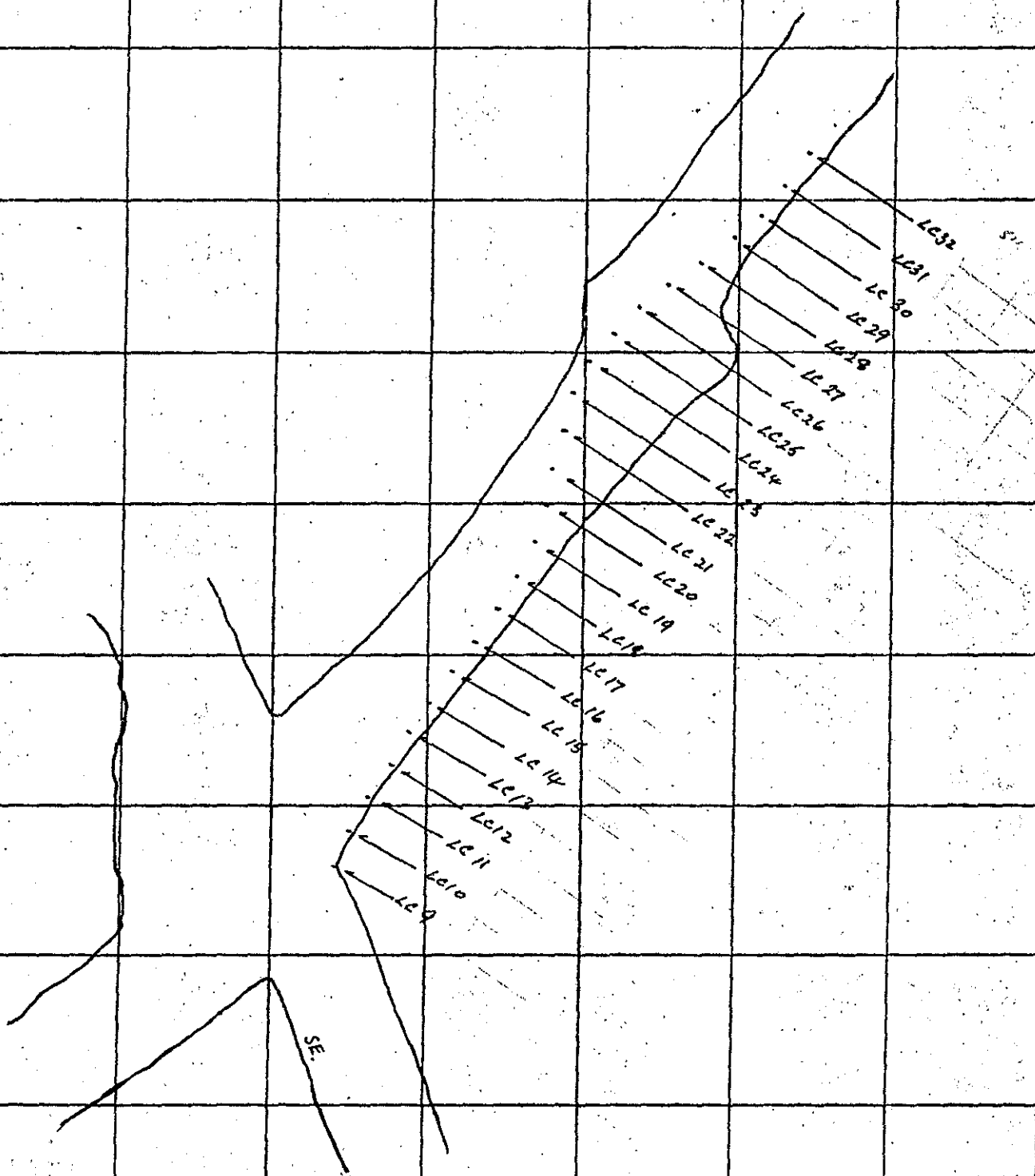

7200 N

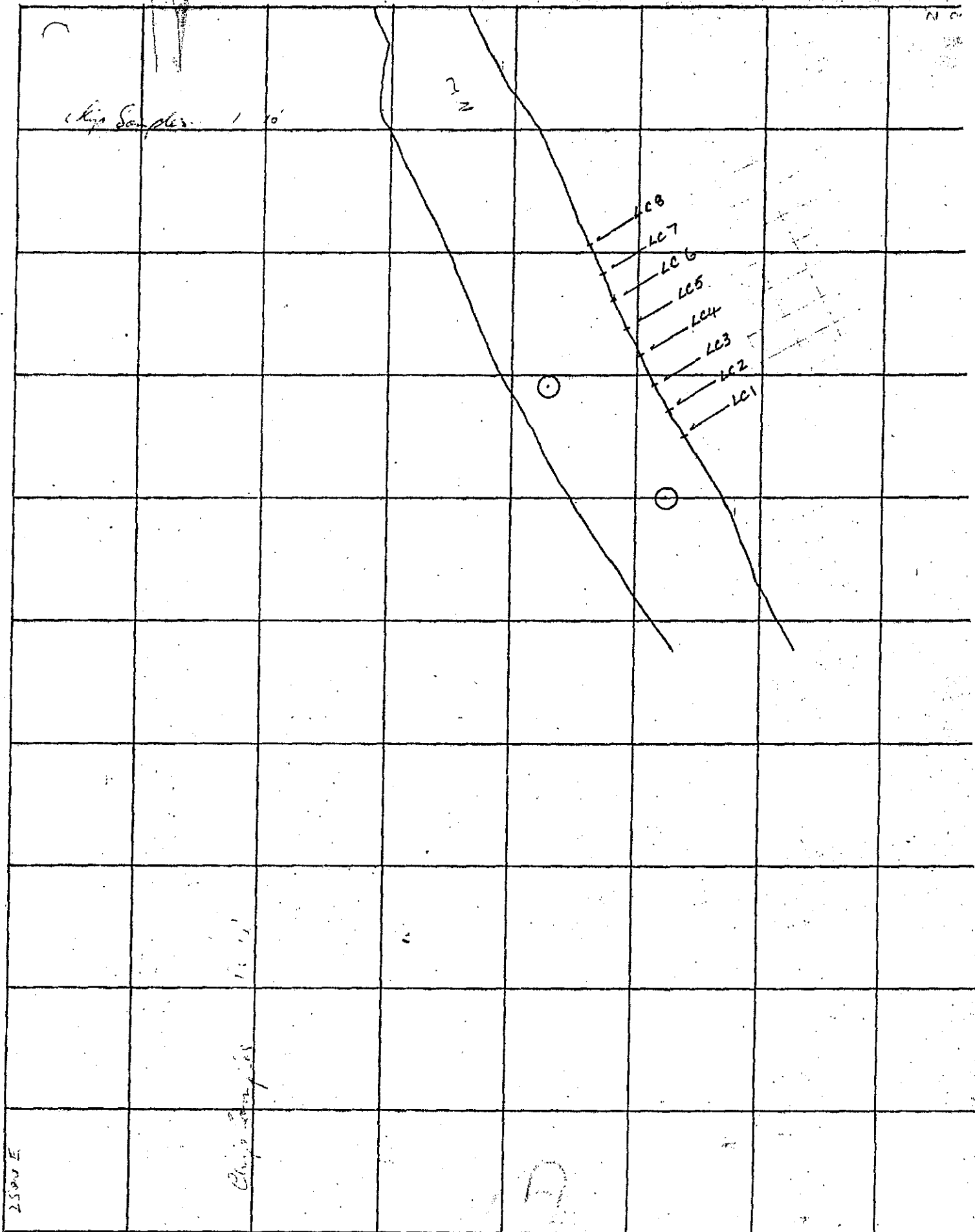

Autopsy & Assay Results

PROGRESS REPORT FOR PERIOD ENDED

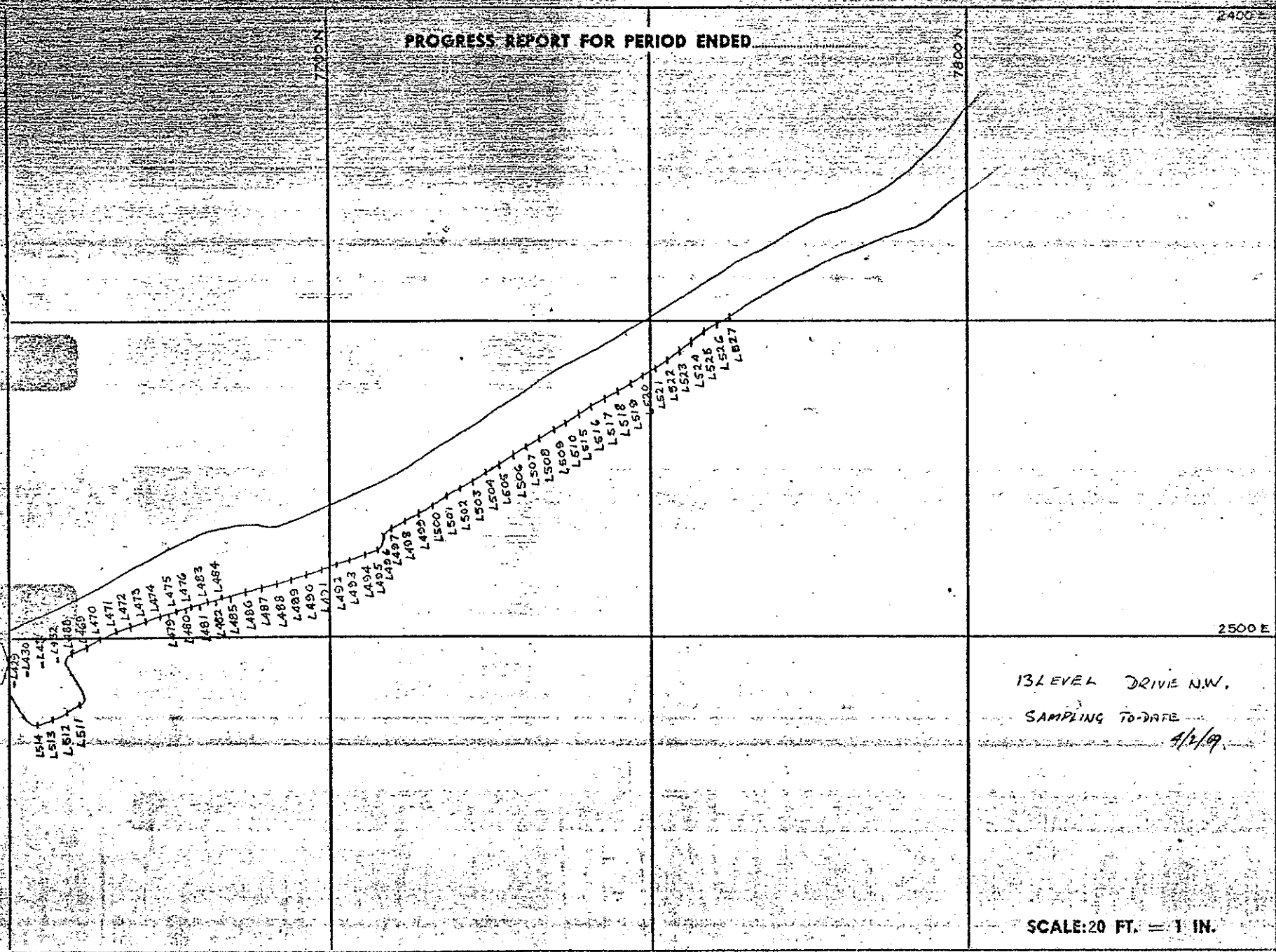

To: Mr. J. M. Jones, Mines Super, U/g. Mgr. (Aberfoyle), Foremen (Aberfoyle - 1 copy) 3-12-69
From: Technical Assistant.

Subject: Visual Grade Estimation Results, Pay 1079, Pd 6

Party	Average Estimated Grade		Special Attention	Remarks
	This Pay	Last Pay		
1	307.5 ENV 2.01 81.0	112.5 1.18 26.9		3' to 4' wide. Narrower
2	0.75 79.0	0.76 95.0	WATCH	To 6' wide. Not always graded.
3	0.93 57.1	0.86 110.1		3' to 4' wide. Still improving.
4	0.71 319.2	1.23 87.4	CHECK	3' to 6' wide. Not always graded.
5	1.60 184.0	1.12 131.0		To 8' wide. However grade is good.
6	0.84 12.2	0.72 103.0		3' to 4' wide.
7	0.65 306.9	1.03 180.6	CHECK	3' to 4' wide. Not always graded.
8	1.49 159.5	1.6 118.1		3' to 5' wide. Not always graded.
9	0.93 104.5	0.93 125.3		4' to 6' wide. Not always graded.
10	0.65 36.5	0.83 113.6		3' to 4' wide.
11	0.58 63.2	2.01 39.8	CHECK	Insufficient grades taken. Doubtful accuracy.
12	0.95 79.5	0.97 90.4	CHECK	" " " " " "
14	1.0 15.9	1.31 82.6		3' to 5' wide. Not always graded.
15	0.11	0.81 158.6	CHECK	6' av. width. Some patches trace only.
17	—	2.01 110.4	CHECK	No grades taken.
19	1.51 143.3	0.96 106.8		Occasional grade unrelated to break. Watch
20	1.22 110.5	1.13 44.8		3' to 6' wide. Improving still.
21	1.0 68.7	0.87 76.2		3' wide. Still improving.
22	0.91 67.9	1.27 112.8		3' to 5' wide. Not always graded.
23	0.65 38.5	0.94 199.3	CHECK	4' wide.
24	0.47 40.7	2.12 88.4	CHECK	4' to 5' wide. Not always graded.
26	0.59 149.9	0.34 187.7	CHECK	4' wide. Patchy values.
27	0.92 382.3	1.39 150.3		4' wide. Has struck poor patch.
28	3.16	1.8		3' to 3 1/2' wide.
30	Trace 337.42	Trace 99.2	CHECK	Has not worked recently.
33	1.12 95.9	0.76 241.4		4' wide. Improving.
36	0.70 128.7	1.36 103.9	CHECK	3' wide.
41	0.87 99.4	1.06 110.2		3 1/2' to 4' wide.
42	1.13 104.4	1.62 142.8		4' wide.
55	0.9	0.86		3' to 3 1/2' wide. Narrower.
3729.1 3721		3351.19 3200	see second page.	
= 1.002		1.047		

Taking of grades has started to be neglected in some parties.
Most notable are: 2 Pty.

4 "

7 "

8 "

9 "

11 " (so few as to affect overall accuracy)

12 " " " " " " " "

14 "

17 " (none taken)

22 "

24 "

It is essential that shift bosses take a grade on every face fired if this system is to work at all.

I would like to see standard practice established to ensure that either i) every face is graded before firing, or
ii) every face is graded after firing.

I feel that ii) would be preferable, because the whole face will be exposed for some time before firing. If faces are graded un-systematically, it can result in the same face being graded twice by opposite Shift Bosses, thus giving misleading results.

When grading, the shift boss can estimate the break from the known length of holes, the width exposed, and the height exposed, rather than grade the face and come back later to assess the break.

Small differences will even out, and in the uncommon case of under break, the figure could be amended.

If all Shift Bosses are asked to use the same procedure results will be most reliable

A.S. Gordon

Mine Manager, Aberfoyle Holdings Limited
The Manager, (Mining Division)
Head Office,
~~A XXXXX XXXXXXXXXX~~

6.8.68 1.2.4

LUTWYCHE CHANNEL SAMPLE RESULTS.

For the attention of - Mr. A. C. Mason.

Herewith, as requested, the preliminary channel
sample results from the 13 Level drive intersections
to date.

B. F. Titcombe
Manager.

Copies handed direct to :-

Messrs. Mason, Hughes,
Tester, Murphy,
Glasson.

Copies forwarded to :-

Messrs. Moorfield &
Stevenson.

MEMORANDUM TO:

Messrs. B. F. Titcombe,
D. K. Tester,
G. Krummei

Copy to E. Hughes,
K. R. Glasson

FROM:

A. A. C. Mason

3-10-68

SUBJECT:

Lutwyche Project - Reporting of
Samples and Assays.

I am concerned that, as at 27.9.68 approximately 160 ft. of driving had been completed on No. 13 level in a north-westerly direction and 50 ft. in a south-easterly direction but the only particulars of sampling and assaying that I have received relating to this drive to this date, covers $17\frac{1}{2}$ ft. in a south-easterly direction and 5 ft. in a north-westerly direction. In the circumstances this is not good enough and the period of time taken to cut samples and report assays is out of proportion to the importance and cost of the project. I would, therefore, like you to critically examine the problem and do everything desirable to speed up the processes.

In case there is any misunderstanding of the requirements for sampling and assaying I will summarise them again, as follows:-

1. The sampling should be arranged and supervised by Mr. Krummei.
2. A full time sampler was to be employed under Mr. Krummei's direction. Samples should be taken immediately the respective sampling stations are exposed or in the case of drill core, as soon as it is logged and marked up for sampling.
3. On the day samples are taken, the particulars should be recorded on a "Particulars of Samples for Assay" sheet (form "A" of my memo of June 26) and a copy immediately forwarded by airmail to this office, together with a supporting form of progress sketch. Please do not hold these until the fortnightly report is despatched or until assays are received.
4. Samples should be assayed promptly and as the results are received from the assayer they should be telephoned or telegraphed to either Mr. Tester or myself so that they can be plotted in this office. These assays should be progressively reported at short, regular intervals. At least every few days. If difficulties are being experienced in sampling and assaying I wish to be advised.

Assays from 11 samples over the 22 ft. of vein length referred to above, average 0.22% Sn. and 0.26% WO_3 over $4\frac{1}{2}$ " average true width which contrasts very sharply with the 5 preliminary samples taken on the H.W. vein where exposed in the x-cut at 7380N and 2615E which averaged 1.64% Sn. and 10.30% WO_3 over 9.4" true width which serves to emphasise that much attention must be paid to sampling and caution must be exercised in the evaluation of the Lutwyche intersections.

- 2 -

I would like to go over the whole matter of sampling with you again at the mine at an early date.

A. A. C. Mason
A. A. C. MASON
OCTOBER 1, 1968.

Mine Manager, ATNL
ROSSARDEN.
The Secretary.

19.12.67 1.2.4

For the attention of Mr. H. Stevenson (Copy to Mr. A.A.C. Mason
& Mr. D. Tester)

ASSAY RESULTS AU13-6.

Enclosed is list of assay results for diamond drill
hole AU13-6 (Lutwyche) as requested.

B. F. Titcombe
Manager.

Encl.

A.T.N.L.

Date 18-12-67

To : H. Stevenson, A.A.C. Mason, D.K. Tester.
 From : Senior Geologist.
 Subject: Assay Results, AU 13-6.

The following assay results for 10 samples of vein material from D.D.H. AU 13-6 are reported by the company's assayer:

Description		ASSAY RESULTS.		
Depth	True Width.	P. I. F (% Sn)	% Sn (WET METH.)	% W_3 (WET METHOD)
333'	2"	0.6	0.65	18.29
336 $\frac{3}{4}$ '	2 $\frac{1}{2}$ "	< 0.1	0.07	0.06
367'	1 $\frac{1}{2}$ "	< 0.1	0.05	0.08
372'	1 $\frac{1}{2}$ "	< 0.1	0.05	0.07
372 $\frac{1}{2}$ '	1 $\frac{1}{2}$ "	< 0.1	0.07	0.04
392'	2 $\frac{1}{4}$ "	1.3	1.10	0.06
408 $\frac{1}{2}$ '	2 $\frac{1}{4}$ "	1.9	1.55	12.98
498'	4"	< 0.1	0.06	22.55
504 $\frac{3}{4}$ '	10"	5.3	5.50	1.58
546 $\frac{1}{4}$ '	3"	< 0.1	0.06	0.72

[Signature]
[Signature]

FILE

REF. 1.13.4

4th August, 1971.

SAMPLING RESULTS LUTWYCHE VEIN - 13 LEVEL6035N 1890E

Channel samples from this vein have been assayed for tin and wolfram and the results are on attached sheet. Although forty four samples were taken, the first eight were misplaced and their whereabouts is unknown. Another sample No. 40 was lost during sample preparation.

Samples were taken at one foot intervals along the vein, perpendicular to the vein walls. Each sample consisted of the material cut from a 1" x 1" groove across the width of the vein. Where echelons occurred, the sample consisted of material cut from both parts of the echeloned vein. Three echelons necessitated this process, involving samples 14, 15, 16(1st), 36(2nd) and 43, 44(3rd).

Subsequent calculations using assay results yielded the following tin and wolfram values.

	<u>AV. WIDTH</u>		
<u>ASSAY ALONG STRIKE</u>	1.44% WO ₃	0.15% SnO ₂	4.17"
<u>ASSAY DOWN DIP</u>	0.53% WO ₃	0.02% SnO ₂	5.57"
<u>OVERALL VEIN ASSAY</u>	1.21% WO ₃	0.12% SnO ₂	4.45"

Taken Over a 48" Driving Width.

Drive Assay = .112% WO₃ .011% SnO₂



A. Finney
Geologist.